

2025 Hot In-Place Recycling

November 22, 2024

HIGHWAY AND TRANSPORTATION MAP

WINNEBAGO COUNTY IOWA



Prepared By
SYSTEMS PLANNING BUREAU
Phone: (515) 239-1664
WWW.IOWADOT.GOV/MAPS

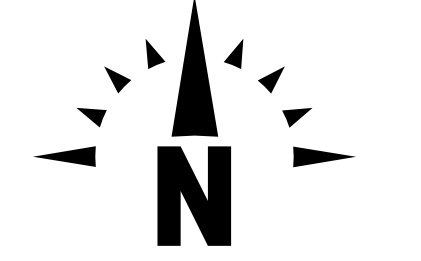

In Cooperation With
United States
Department of Transportation

JANUARY 1, 2022

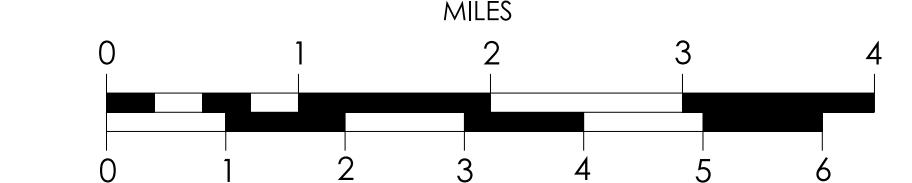

LEGEND

- DIVIDED HIGHWAY
- PAVED ROAD
- BITUMINOUS ROAD
- GRAVEL ROAD
- EARTHEN ROAD
- INTERSTATE HIGHWAY
- UNITED STATES HIGHWAY
- STATE HIGHWAY
- COUNTY HIGHWAY
- RAILROAD
- PIPELINE
- AIRPORT
- HYDROLOGY
- BRIDGE
- STATE BOUNDARY
- COUNTY BOUNDARY
- CORPORATE BOUNDARY
- TOWNSHIP LINE
- SECTION LINE
- ROAD NAMES
- UNINCORPORATED PLACE
- STATE PARKS
- STATE INSTITUTIONS
- FEDERAL LAND

Project ID: LFM-R20North--7X-95
Road: R20 North
Scope: HMA Paving (1" Mill, 2" HIR & 1-1/2" Asphalt Overlay)
Cost: \$2,200,000

Project ID: LFM-RakeArea--7X-95
Road: 500th St, Grace St, 30th Ave (See larger map lower right corner)
Scope: HMA Paving (1" Mill, 2" HIR & 2" Asphalt Overlay)
Cost: \$1,100,000

Project ID: L-ASMUS--73-95
Road: 40th Ave. & 500th St.
Scope: 1. HMA Pavement - Grade & New
2. 2" HIR, 3" Asphalt Overlay
Cost: \$1,400,000

Project ID: LFM-R50/A30--7X-95
Road: R50 Middle & A30 East
Scope: 2" Hot In-Place Recycle
Cost: \$490,000

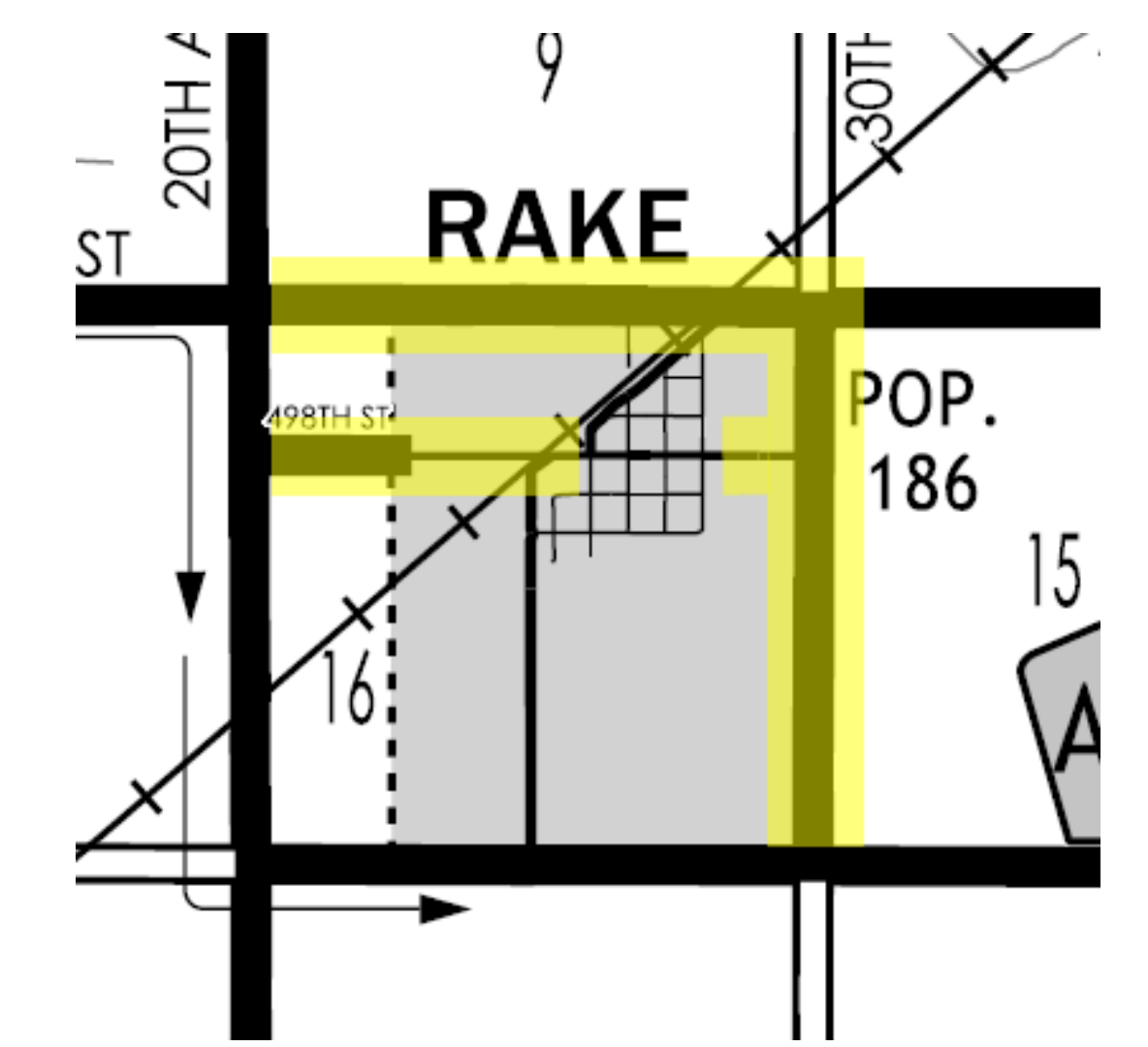
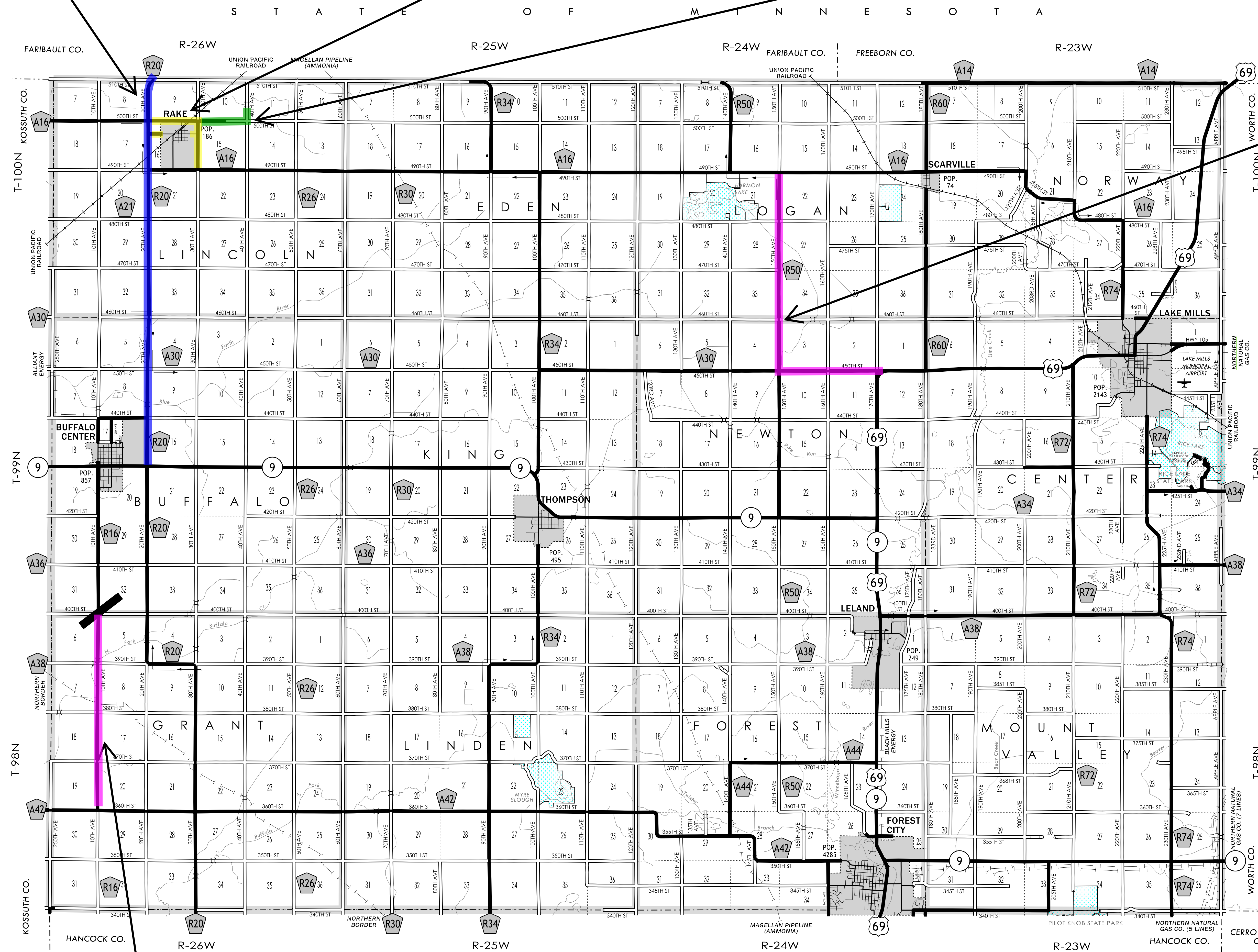

Project ID: LFM-R16South--7X-95
Road: R16 South
Scope: 2" Hot In-Place Recycle
Cost: \$375,000

